

LightCraft

26m Emergency Response Vessel



SCY Design

48 Sweetgum St, Ashmore Qld 4214, Australia
Ph: (617) 5597 3521 www.scy.net.au



26m Emergency Response Vessel

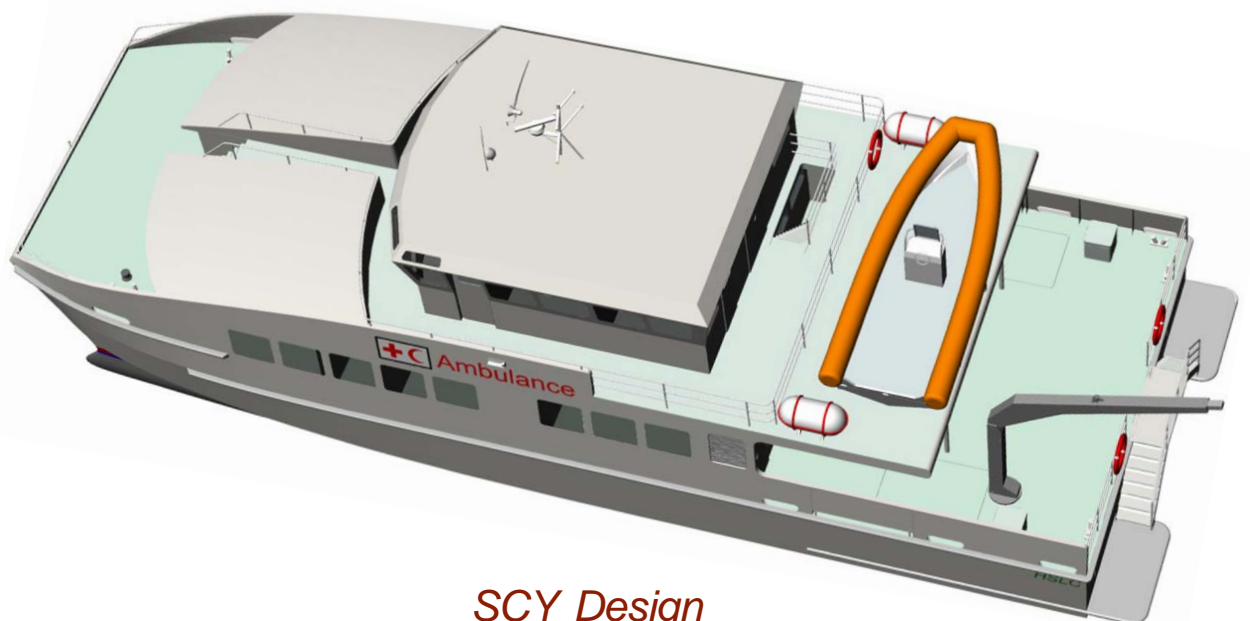

SCY Design

48 Sweetgum St, Ashmore Qld 4214, Australia
Ph: (617) 5597 3521 www.scy.net.au

26m Emergency Response Vessel

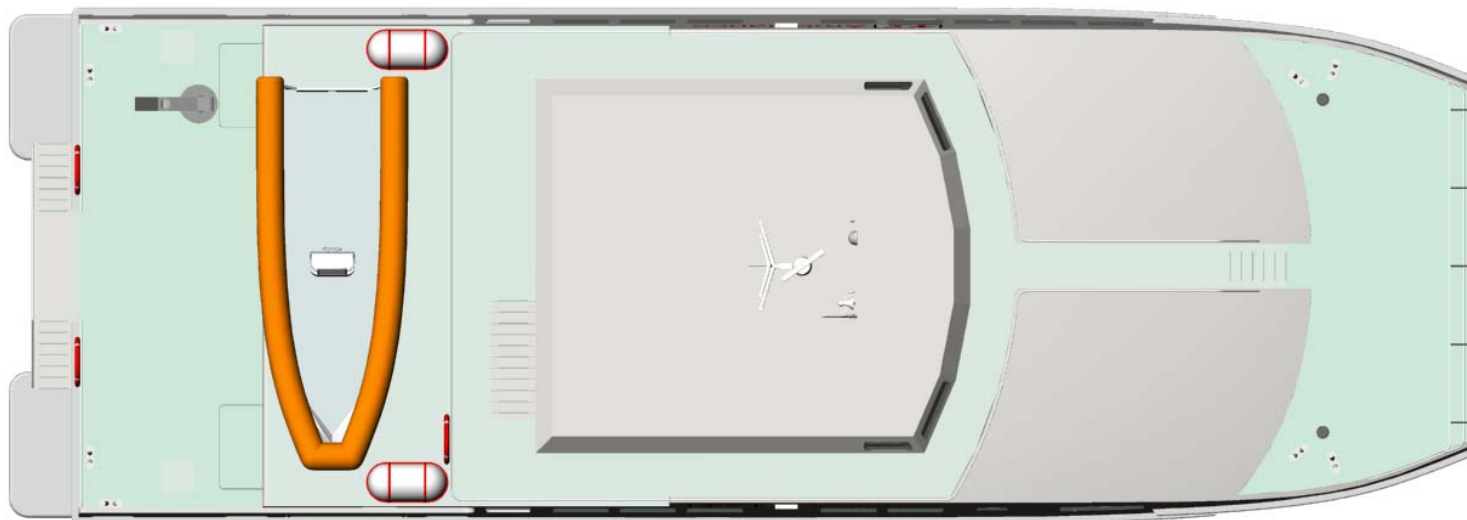
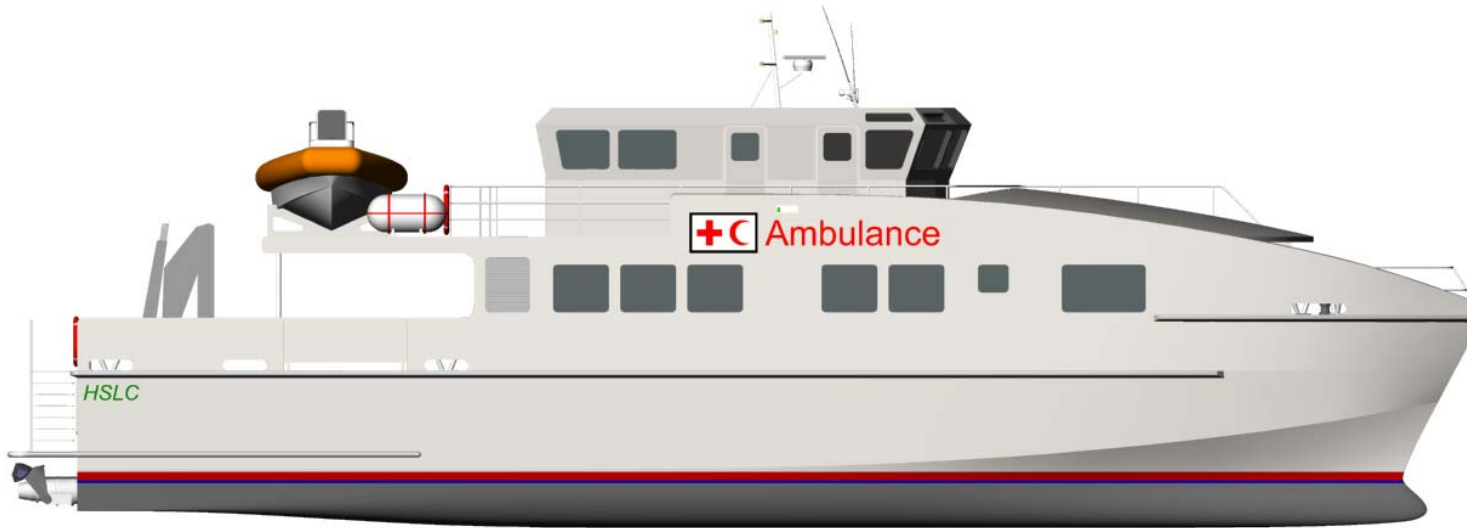

PRINCIPAL DATA

LOA :	26.4m
LWL :	23.7m
Beam :	9.0m
Draft :	1.10m
Berths :	8-25

SCY Design

48 Sweetgum St, Ashmore Qld 4214, Australia
Ph: (617) 5597 3521 www.scy.net.au



26m ERV

Vessel Description

VESSEL TYPE: High Speed Aluminium Catamaran for coastal service, round bilge “semi-swath” hullform incorporating bulbous bows.

SURVEY AND CLASSIFICATION:

The vessel shall be classed Det Norske Veritas (DNV) with the notation ✕1A1 HSLC R3 Patol, and shall comply with the requirements of Queensland Survey USL 2B

STRUCTURE:

Materials (to be inspected as required by Survey Authority and Owners Representative):

Sheet and Plate - Grade 5083-H321, H116, 5086-H32

Extrusions - Grade 6061-T6, 6082-T5, Filler Wire - Grade 5356, Castings - Grade CC601-T1

OUTFIT AND FINISHING: The vessel shall be laid out as per the general arrangement drawings and all fittings and equipment required for the operation of the vessel shall be supplied.

FITOUT Floors: Internal : “Aquadeck”
External Decks : Non-skid paint
Linings: Sides: Aluminium honeycomb panels (Ayr-lite)
Bulkheads: Aluminium honeycomb panels (Ayr-lite)
Deckhead: “Luxalon” perforated aluminium

AIR CONDITIONING SYSTEM: System is based on an water cooled compressor unit linked up to a multiple number of fan coil units. Design of the system shall be based upon an ambient operating temperature of 35°C (90% RH) and sea water of 32°C. Crew and Passenger spaces to be cooled to 21°C (50% RH).

NAVIGATION and COMMUNICATION EQUIPMENT:

Furuno Model 1510 15” Radar with 6ft antenna 15mtr cable ARP17 Plotter GCY8 Gyro converter

JMC 1400 Dual frequency sounder 50/200 1kw

JMC NP-30NT with GPS ANTENNA

ICOM-IC-M700 complete with tuner and Banten HF antenna

Icom IC-M502 VHF Radio with Banten antenna

Sailor C2906 Inmarsat C VMS unit

KVH Trac phone Inmarsat M

Navicontrol Autopilot 3003 Gold with second station

Cetrek “Poseidon” compass

Den Haan DHR CS-220 Searchlight

Closed circuit TV monitoring of engine room and main deck. All navigation equipment interfaced to Bridge displays



SCY Design

48 Sweetgum St, Ashmore Qld 4214, Australia

Ph: (617) 5597 3521 www.scy.net.au

26m Emergency Response Vessel

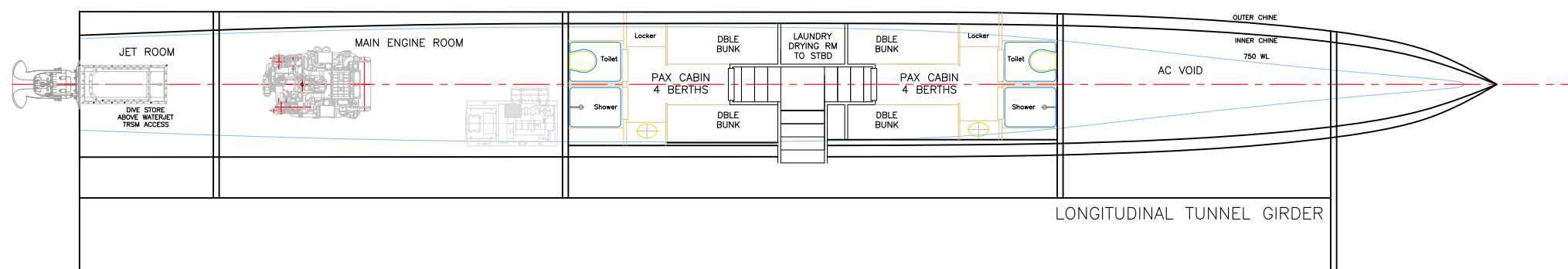
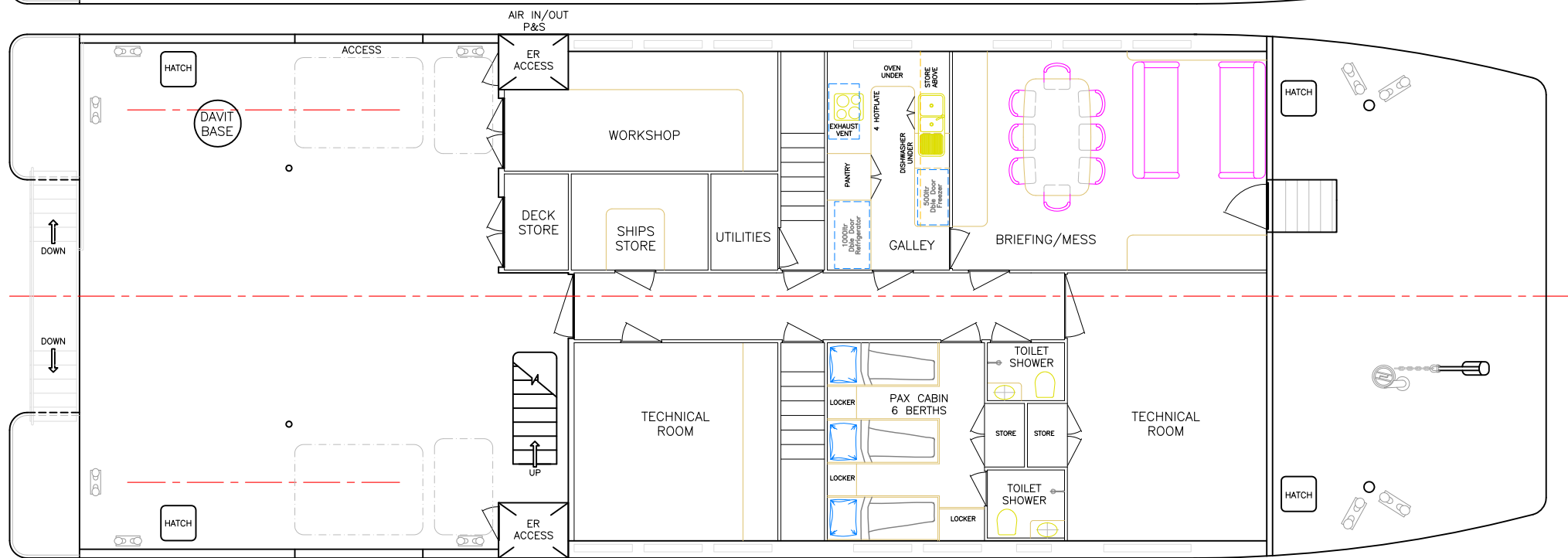
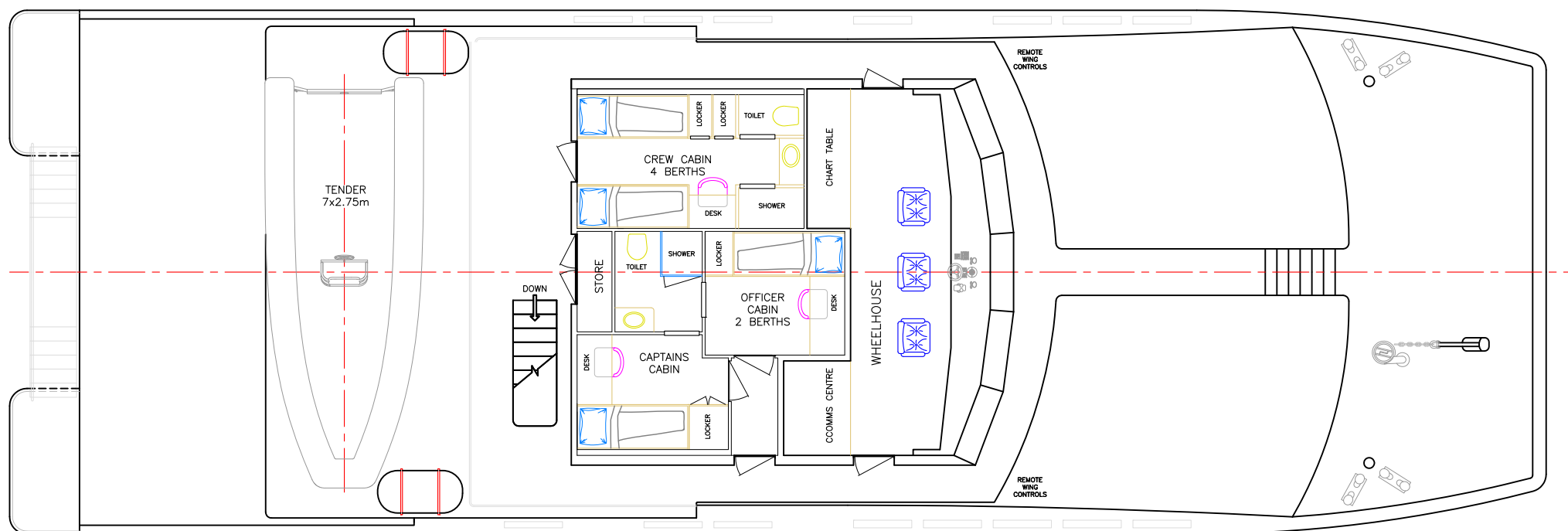
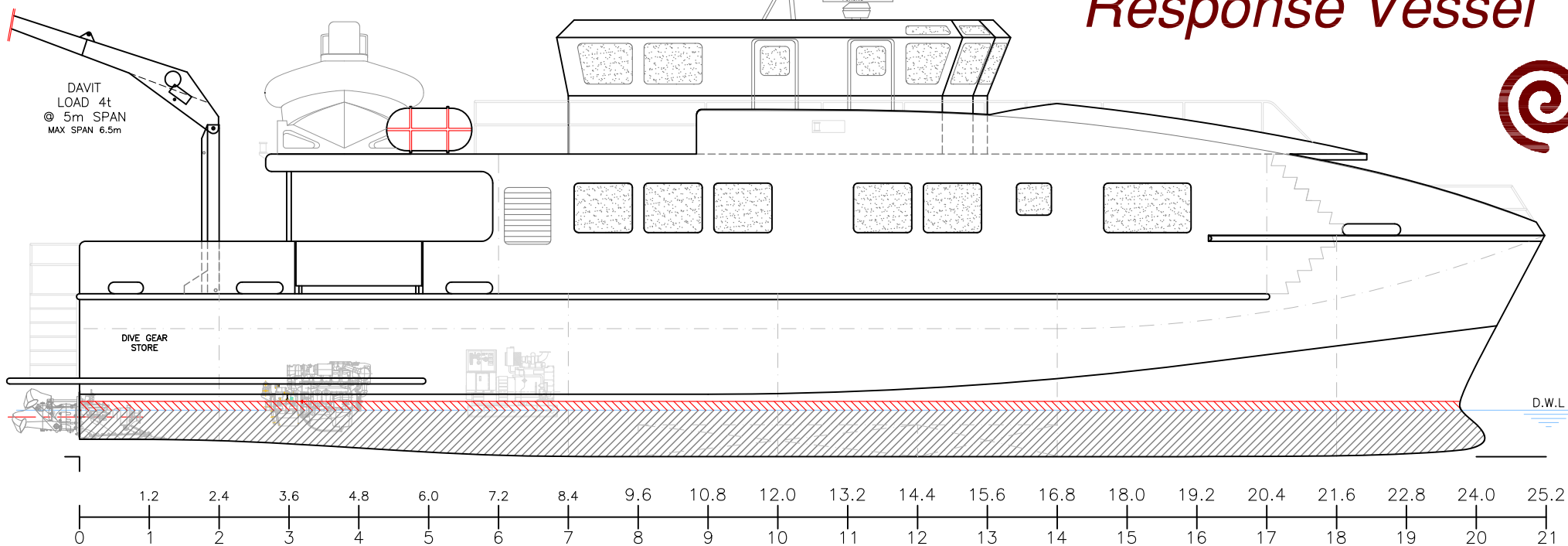

LOA: 26.4m
Lmoulded: 25.2m
LWL: 23.7m
BEAM: 9.0m
DRAFT: 1.2m

FUEL: 7500lts
WATER: 3000lts
BERTHS: 7+22
SPEED: 25knots

MAIN ENGINES: 2 x MAN D2842 LE405
662kW @ 2100rpm
GEARBOX: 2 x ZF2050
PROPULSION: 2 x HAMILTON HJ403
AUXILLARY: 2 x 65ekW

LightCraft
Aluminium Workboats

VESSEL: 26m Emergency Response Vessel

TITLE: GENERAL ARRANGEMENT

DWG No: S26-100

DATE: 5/1/2013

SCALE: 1:- A4

DRAWN: MDW

copyright ©

THIS DRAWING AND THE INFORMATION CONTAINED HEREON IS SUPPLIED ON THE UNDERSTANDING THAT IT IS THE EXCLUSIVE PROPERTY OF SOUTHPORT CUSTOM YACHTS PTY. LTD. AND MUST NOT BE USED OR REPRODUCED IN WHOLE OR IN PART WITHOUT PERMISSION IN WRITING.

SCY DESIGN
Consulting Naval Architects & Mechanical Engineers
48 Sweetgum St, Ashmore, Queensland 4214, Australia
Ph: 617 5597 3521 www.scy.net.au

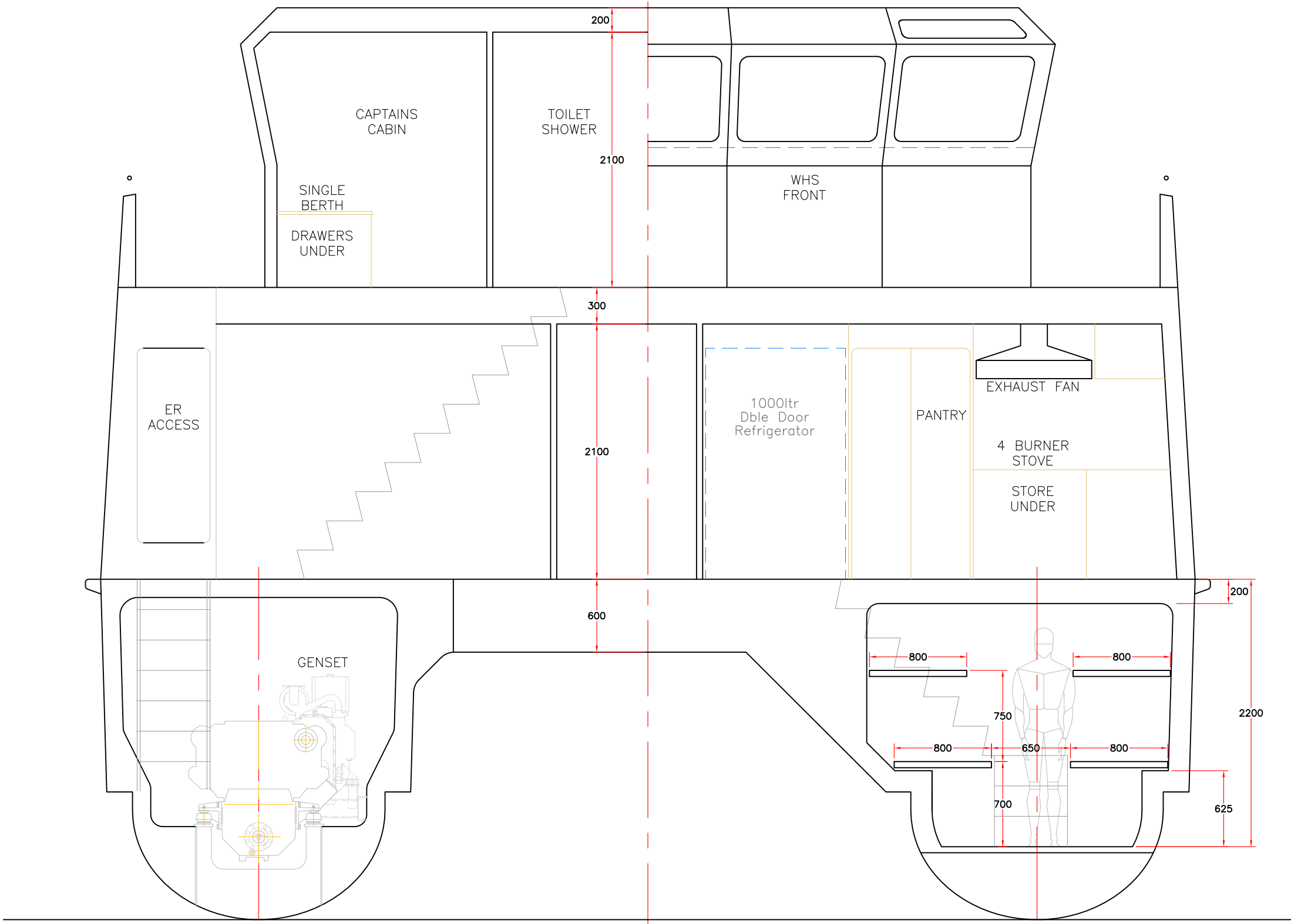

SECTION THROUGH
FRAME 17

SECTION THROUGH
FRAME 9